

Adjustable Gate Eyebolts Supplied with Two Nuts

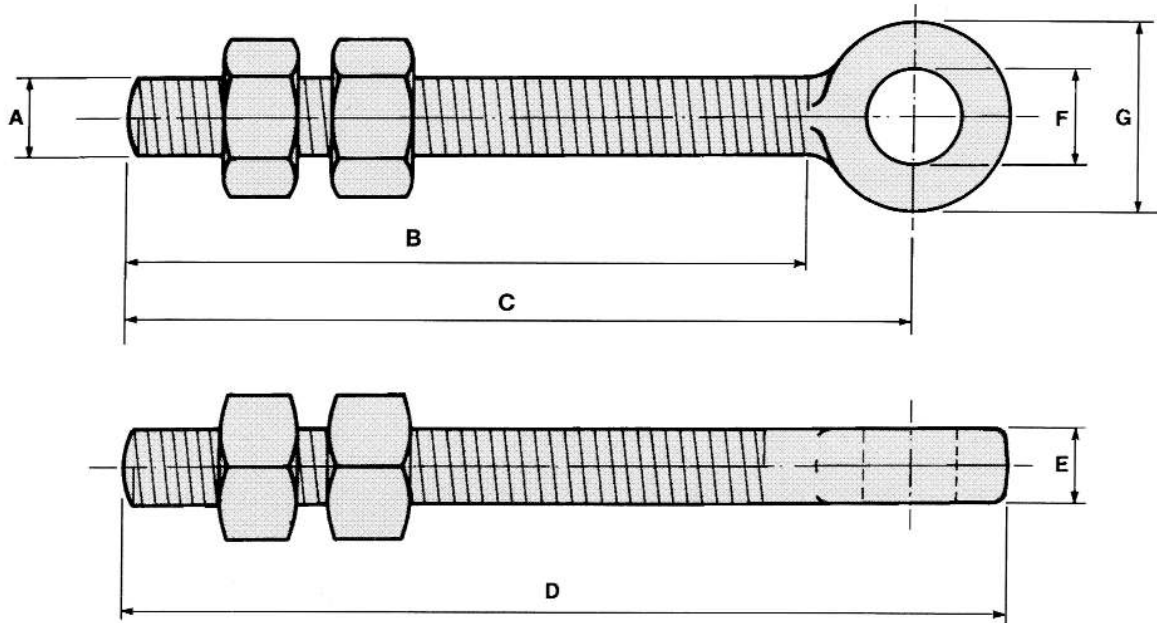

**BFG
1**

TO SUIT PIN DIA		A METRIC THREAD	B		C		D		E		F		G		Weight Each
inches	mm	mm	inches	mm	inches	mm	inches	mm	inches	mm	inches	mm	inches	mm	kgs
1/2	12	M12	4. 1/2	115	5. 1/8	130	5. 3/4	146	15/32	12	9/16	14	1. 1/4	32	0.20
5/8	16	M16	4. 1/2	115	5. 1/4	133	6	152	20/32	16	11/16	18	1. 1/2	38	0.35
3/4	20	M16	4. 1/2	115	5. 1/4	133	6	152	20/32	16	13/16	21	1. 1/2	38	0.34
5/8	16	M16	6	152	6. 3/4	172	7. 1/2	190	20/32	16	11/16	18	1. 1/2	38	0.41
3/4	20	M16	6	152	6. 3/4	172	7. 1/2	190	20/32	16	13/16	21	1. 1/2	38	0.40
3/4	20	M20	4. 1/2	115	5. 3/8	137	6. 1/4	159	25/32	20	13/16	21	1. 3/4	45	0.59
7/8	22	M20	4. 1/2	115	5. 3/8	137	6. 1/4	159	25/32	20	15/16	24	1. 3/4	45	0.57
3/4	20	M20	6	152	6. 7/8	175	7. 3/4	197	25/32	20	13/16	21	1. 3/4	45	0.59
7/8	22	M20	6	152	6. 7/8	175	7. 3/4	197	25/32	20	15/16	24	1. 3/4	45	0.61
3/4	20	M20	8	204	8. 7/8	225	9. 3/4	248	25/32	20	13/16	21	1. 3/4	45	0.71
7/8	22	M20	8	204	8. 7/8	225	9. 3/4	248	25/32	20	15/16	24	1. 3/4	45	0.69
3/4	20	M20	10	254	10. 7/8	276	11. 3/4	299	25/32	20	13/16	21	1. 3/4	45	0.83
7/8	22	M20	10	254	10. 7/8	276	11. 3/4	299	25/32	20	15/16	24	1. 3/4	45	0.81
3/4	20	M22	6	152	6. 7/8	175	7. 3/4	197	55/64	22	13/16	21	1. 3/4	45	0.74
7/8	22	M22	6	152	6. 7/8	175	7. 3/4	197	55/64	22	15/16	24	1. 3/4	45	0.72
1	25	M24	6	152	7	178	9	229	30/32	24	1. 1/16	26	2	50	0.98
1. 1/8	28	M30	6	152	7. 3/16	183	8. 3/8	213	1. 3/16	30	1. 1/4	32	2. 3/8	60	1.66
1. 1/4	32	M30	6	152	7. 3/16	183	8. 3/8	213	1. 3/16	30	1. 3/8	35	2. 3/8	60	1.64

© Brooks Forgings Ltd 2008

SPECIFICATIONS AVAILABLE

MATERIAL

CARBON STEELS

NON STANDARDS

AVAILABLE TO SUIT

CUSTOMERS REQUIREMENTS

FINISH

- SELF COLOUR
- GALVANISED
- ELECTROPLATED
- CHEMICAL BLACK
- SHERADIZED